









## MOWER COUNTY ZONING MAPS

	AGRICULTURAL
	R-1
	INDUSTRIAL
	BUSINESS
	RURAL SERVICE CENTER
	RURAL MANAGEMENT
	URBAN EXPANSION
	FREEWAY INTERCHANGE MANAGEMENT

Existing Residential Plats – Whether or not they are so designated on the zoning map, residential plats where were approved prior to the effective date of this ordinance shall be considered as though zoned Residential regardless of the primary or underlying zoning district in which they are located.

# MOWER COUNTY, MINNESOTA

T. 104 N.	UDOLPHO	WALTHAM	SARGEANT	PLEASANT VALLEY	RACINE
T. 103 N.	LANSING	RED ROCK	DEXTER	GRAND MEADOW	FRANKFORD
T. 102 N.	AUSTIN	WINDOM	MARSHALL	CLAYTON	BENNINGTON
T. 101 N.	LYLE	NEVADA	ADAMS	LODI	LE ROY
	R.18W.	R.17W.	R.16W.	R.15W.	R.14W.

# RACINE

# T.103-104N.-R.14W. 23

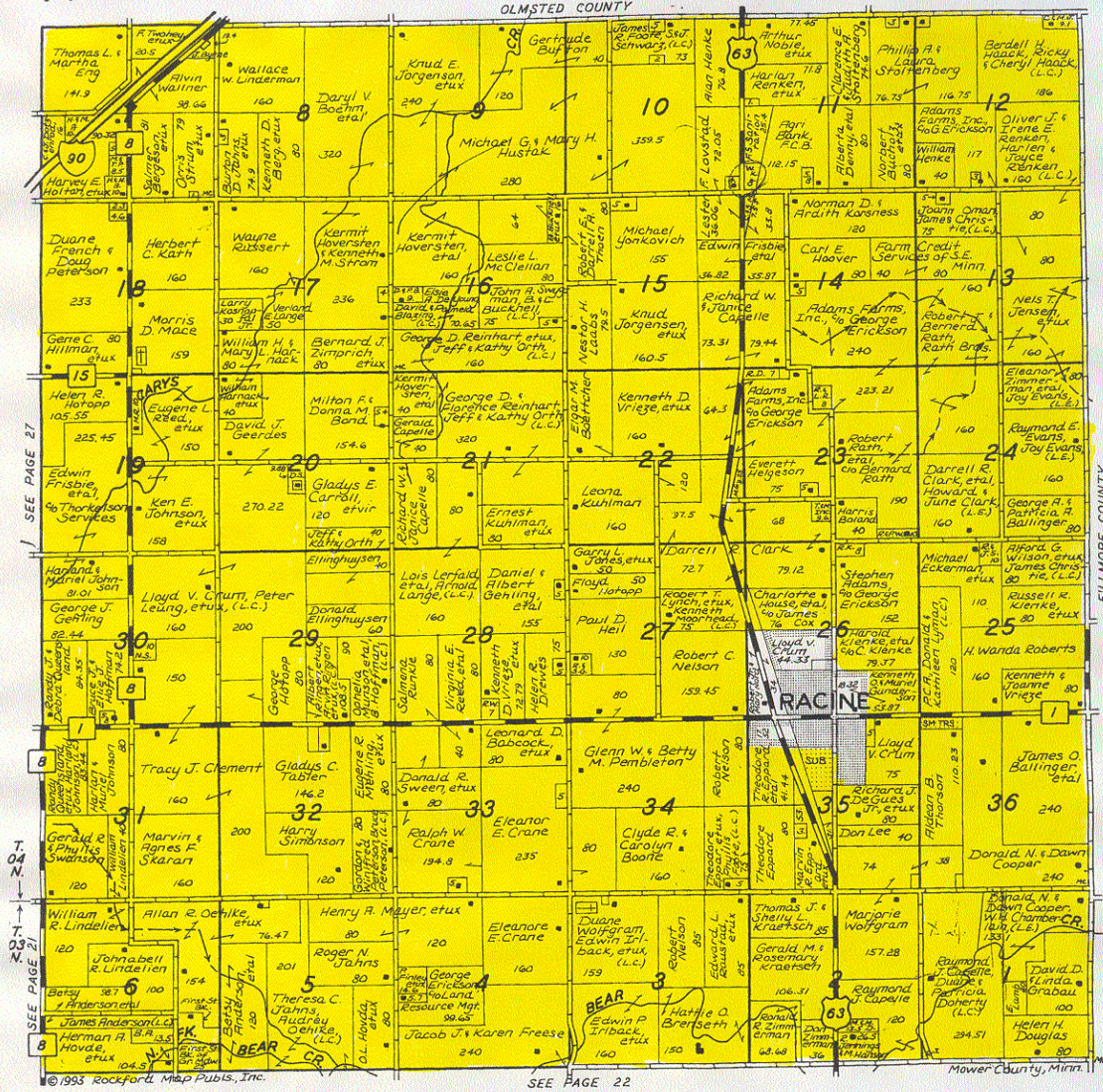

All property outside the city limits of Racine is "Rural Management"